

Courses and Distances of the River from the Elm

- N 27 W 16 ps
- N 34 W 12-
- N 36 W 62-
- N 50 W 43-
- N 63 W 36-
- N 84 W 12-
- S 78 W 18. to
- a Spruce 199-

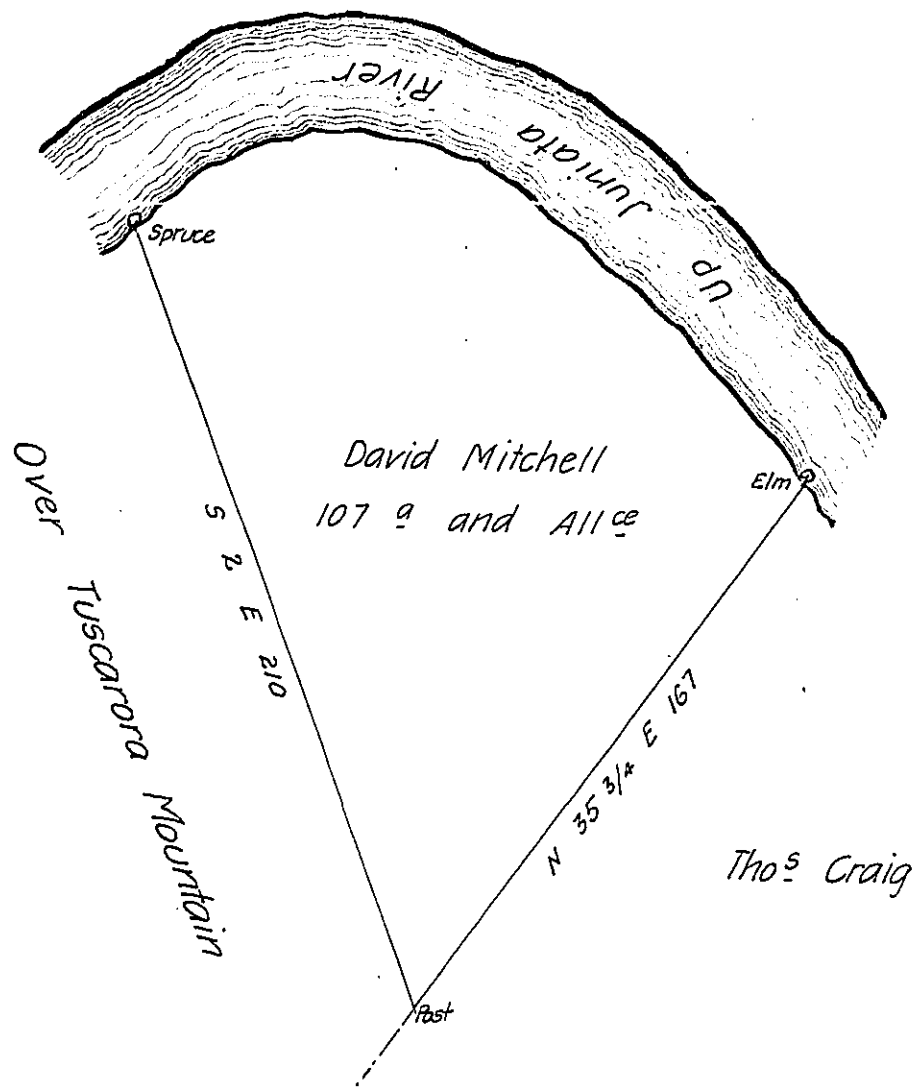

Draught of a Tract of Land Situate in Cumberland & Mifflin Counties Containing One hundred and Seven Acres and Allowance of 6^o Pr Ct for Roads & Surveyed May 2nd 1794 in pursuance of a Warrant granted to David Mitchell bearing date 17th of Jan^y 1794

P^r

Sami^l Lyon D.S.

To Daniel Brodhead Esq^r
Surveyor General

IN TESTIMONY that the above is a copy of the original remaining on file in the Department of Internal Affairs of Pennsylvania, made conformably to an Act of Assembly approved the 16th day of February, 1833, I have hereunto set my Hand and caused the Seal of said Department to be affixed at Harrisburg, this fifteenth day of November 1905

Joseph P. Brown
Secretary of Internal Affairs.